

ROADEO

2017



PPTA 
Pennsylvania Public Transportation Association



Operators' Roadeo

1. Scheduled activities

Please refer to the program for a more detailed schedule of events, times and places.

1.1 Saturday

Passenger Assistance/Wheelchair Securement, Paratransit Test & Pre-trip inspection

1. Operators will perform a Pre-Trip Inspection that will be scored.
2. There is no practice for these events. At Registration, Operators will be assigned a number to report for the Pre-Trip Inspection Competition and Passenger Assistance/Wheelchair Securement.
3. Operators will report to the staging area for the Pre-Trip Inspection and Passenger Assistance/Wheelchair Securement.
4. The Passenger Assistance/Wheelchair Securement & Pre-Trip Inspection Competition is mandatory for all competing operators and is included in the final scoring.
5. The Paratransit Testing is mandatory for Paratransit Operators completing.

1.2 Sunday

Competition

1. Operators are required to report to the Staging area at the Roadeo site at least 30 minutes prior the start of the competition to complete the Driver Walk Through. Operators who report late on competition day may be disqualified from competition.
2. On competition day, operators will be judged on appearance and driving skills only.
3. On competition day, operators will not be tested with a safety quiz or defective bus test.
4. Operators must be in the full regulation uniform of their transit system for competition inspection. Upon completion of the inspection, operators will be allowed to remove coats and ties, if desired.
5. Each course is uniquely engineered for every Roadeo. Therefore, the order of events (obstacles) may be laid out differently than shown in this handbook. However, the construction of each obstacle will be in accordance with the provisions stated in this handbook.
6. Roadeo Officials will attempt to utilize the measurements set forth in this handbook; however, Roadeo Officials reserve the right to make changes based on the space available at the Roadeo site and equipment variations. The course will be verified by the On-field Officials to ensure that all obstacles are negotiable with the equipment provided.

2. Equipment

1. Operators will compete using either a 35-foot bus or Paratransit vehicle.
2. Operators must drive the vehicle size selected when initially registered.

3. Competition events

3.1 Pre-trip inspection

3.2 Competition – Saturday

The Pre-Trip Inspection competition is mandatory and an important part of your overall score. This can sometimes be the difference between being the champion or not. In order to identify the planted defects, it is important to have a systematic approach to the pre-trip inspection to ensure complete coverage of the bus. It is highly recommended you prepare for this competition event and you spend time to familiarize yourself.

3.2.1 Defects

1. Eight (8) equipment-related defects and one (1) security hazard are planted on or in a bus. These defects would make a bus operationally unready or unsafe.
2. Defects are of a type that an operator would find when performing a pre-trip inspection.
3. Identification of defects does not require starting the bus or crawling under the bus.
4. Operators will not be allowed to have a checklist of defects to refer to during the competition.

5. Eligible defects might include broken, loose, bad, missing, or incorrect:
 - seats
 - any type of lights
 - windows
 - stanchions
 - flooring
 - fire extinguisher
 - windshield
 - wipers
 - mirrors
 - number
 - doors
 - license plate
 - bell cord

And a security hazard such as an abandoned package or briefcase.

6. Ineligible defects include:
 - defects under the bus
 - exterior body damage
 - paint problems
 - wheelchair operations
 - kneeling functions
 - radios
 - fare boxes
 - destination signs
 - battery compartment

7. Equipment where multiple defects are possible will be counted only once i.e., seats, windows, lights.
8. Front and rear windows, headlights, tail lights, brake lights, mirrors, and turn signals will each count as separate defects.

3.2.2 Time

1. Each operator will be allotted eight (8) minutes to inspect, locate, identify, and legibly speak any defects found.
2. Recording defects, returning bus to original condition and securing doors will not be allowed after time has elapsed.

3.2.3 Scoring

1. Five (5) points will be awarded for each of eight (8) planted defects found, and ten (10) points will be awarded for one (1) planted security challenge for a maximum of fifty (50) points.
2. Points will be awarded only for those recorded defects that were planted by the judges. No points will be awarded for identification of defects which were not planted.
3. The operator will notify the judge when finished if completed prior to the 8 minute time limit. Once notice is given, the operator may not list additional defects.
4. The judge will review the list of defects with each operator for clarification.

Starting the bus constitutes a safety violation and will result in the operator being disqualified from this event. The inspection bus will be supplied with necessary electrical power and air pressure

3.3 Pre-Trip Inspection

1. There are a maximum of 50 points for the Pre-Trip Inspection.
2. The highest score for the Pre-Trip Inspection will be recognized by a separate award. The sponsor will provide an award to the winner of this event.

3.4 Operators' Obstacle Course

The eleven driving obstacles are worth 50 points each. See Appendix 4 for operators obstacle descriptions. **Reckless use of equipment and flagrant disregard for the safety of others may result in immediate disqualification.**

3.4.1 Serpentine

1. This obstacle tests the operator's ability to negotiate tight turns. The driver enters the course through a 'gate' and steers in and out through three (3) cones and exits the course through a 'gate.'
2. Points will be deducted for:
 - touching cones
 - shifting into reverse
 - not completing course as designed

3.4.2 Offset Street

1. This obstacle requires the operator to drive through two separate narrow lanes that are offset to the right one full lane's width from each other.
2. Points will be deducted for:
 - touching cones
 - shifting into reverse
 - not completing course as designed

3.4.3 Rear Duals Clearance

1. This is an obstacle where the operator must drive through a lane with the right dual tires. The lane is only slightly wider than the total outside width of a pair of rear duals and is marked with large flat washers and tennis balls. The lane diminishes in width from the entrance to the exit.
2. Points will be deducted for:
 - touching balls
 - shifting in reverse
 - not completing course as designed

3.4.4 Right-Hand Turn

1. This obstacle tests the operator's ability to negotiate a tight 90° turn. The corner is marked with cones and the right rear tire of the bus is to pass within six (6) inches of the corner cone.
2. Points will be deducted for:
 - touching cones
 - shifting into reverse
 - excessive right rear tire clearance
 - not completing course as designed

3.4.5 First Customer Stop

1. This event simulates a customer stop. The operator should stop the vehicle with the front tires within six (6) inches of the simulated curb. Rear tires must be within 15 inches of the simulated curb. After stopping the vehicle, the **operator is required to open the door to complete the test**. An ADA stop announcement must be made prior to exiting the passenger stop.
2. Points will be deducted for:
 - touching cones
 - touching 'curb'
 - front tire measurement over six (6) inches
 - rear tire measurement over 15 inches
 - shifting into reverse
 - not completing the course as designed

3.4.6 Left-Hand Reverse

1. This obstacle tests the operator's ability to back the vehicle between two obstacles which requires the vehicle to back up to the left.
2. Points will be deducted for:
 - touching cones
 - shifting into reverse after the initial reverse
 - rear clearance beyond 36 inches
 - not completing the course as designed

3.4.7 Left-Hand Turn

1. This obstacle tests the operator's ability to make a tight left turn in a close situation. The contestant is required to steer the vehicle into a 90° turn without touching any of the cones.
2. Points will be deducted for:
 - touching cones
 - shifting into reverse
 - not completing course as designed

3.4.8 Second Customer Stop

1. This event simulates another customer stop. The operator should stop the vehicle with the front tires within (six) 6 inches of the simulated curb. Rear tires must be within 15 inches of the simulated curb. After stopping the vehicle, the **operator is required to open the door to complete the test.** An ADA stop announcement must be made prior to exiting the passenger stop.
2. Points will be deducted for:
 - touching cones
 - touching 'curb'
 - front tire measurement over six (6) inches
 - rear tire measurement over 15 inches
 - shifting into reverse
 - not completing the course as designed

3.4.9 Right-Hand Reverse

1. This obstacle tests the operator's ability to back up the vehicle between two obstacles which requires the vehicle to back up to the right.
2. Points will be deducted for:
 - touching cones
 - shifting into reverse after the initial reverse
 - rear clearance beyond 36 inches
 - not completing the course as designed

3.4.10 Diminishing Clearance

1. This obstacle tests the operator's ability to judge the position and speed of his/her vehicle. The contestant is required to drive through a narrowing, V-shaped channel outlined with barrels. The bus must obtain a minimum speed of 20 miles per hour within the obstacle.
2. Points will be deducted for:
 - touching barrels
 - speed below 20 miles per hour
 - not completing the course as designed

3.4.11 Judgment Stop

1. This event tests the operator's ability to judge stopping distances between the bus and a small object directly ahead. A small cone is placed on the final stop. The operator must stop with the front bumper or bike rack within six (6) inches of the cone.
2. Points will be deducted for:
 - touching cone
 - excessive total stops
 - excessive clearance beyond six (6) inch limit
 - not completing the course as designed

3.5 Other scored events

3.5.1 Safety Habits

1. The operator's safety habits will be reviewed while operating the vehicle.
2. This event category is worth 25 points.
3. Points will be deducted for:
 - failure to use proper turn signals
 - failure to sound horn before backing up
 - failure to use flashers while backing up

- moving vehicle with door open
- poor posture
- poor use of mirrors
- poor use of hands
- poor use of feet

3.5.2 Smoothness of Operation

1. The operator's ability to deliver a smooth ride will be evaluated during the driving events.
2. This event category is worth 25 points.
3. Points will be deducted for:
 - failure to make ADA announcements
 - sudden stops
 - sudden starts
 - abrupt turns

3.5.3 Personal Appearance

1. The operator's personal appearance will be evaluated for neatness, cleanliness and professionalism. The contestant must report wearing the uniform appropriate for his/her transit system.
2. This event category is worth 50 points.
3. Points will be deducted for:
 - wrinkled, dirty, incomplete uniform
 - unpolished or dirty shoes
 - unkempt personal appearance
4. Operators who report wearing shoes with heels that exceed 1½ inches will not be allowed to compete unless the shoes are changed prior to competing. Shoe heels built up for medical/corrective purposes will be allowed based on approval by the course judge (chairman or vice chairman).

3.5.4 Total course time

1. Operators are timed for each driving course event. Timing begins when the operator begins the course and ends with the completion of the judgment stop.
2. Time is stopped for mechanical trouble, any type of course blockage that would impede the operator progress and where measurements are required for event scoring.
3. One point is deducted for each second over the seven (7) minutes allotted to complete the course. Maximum deduction is 180 points.
4. **A maximum of 10 minutes will be allowed to complete the course. Operators will be required to vacate the course after 10 minutes.**

3.6 Driving Competition

1. The 35 foot and Paratransit - competitions are two separate competitions.
2. There will be a first, second and third place award in each competition.
3. There are 700 maximum points for the driving portion of the competition.
4. Fifty (50) points will be deducted for obstacles attempted in the wrong order.
5. Ten (10) points will be deducted for any course marker not associated with an event (obstacle) touched.
6. The full value of the event (obstacle) will be deducted for any event not attempted or completed as designed.
7. In case of tie, the tie breakers will be as follows
 - Lowest time on the course
 - Closest measurement to the Judgment Stop cone.
8. Judgment of events (obstacles) will be the responsibility of the Event Judges. All decisions made by Event Judges are final.
9. Procedural questions must be directed to appropriate On-field Rodeo Officials (Chairman or Vice Chairman).
10. Contestants are only allowed on the course when competing.
11. Contestants are not permitted to talk to Event Judges at any time during the competition.
12. Rodeo Officials will enforce all Rodeo 'Rules and Regulations', Supervise event judges, and provide on-the-spot procedural decisions. The Chair of the International Bus Rodeo Committee is the Chief Rodeo Official.

2016 ROADEO LAYOUT - SCRANTON PA

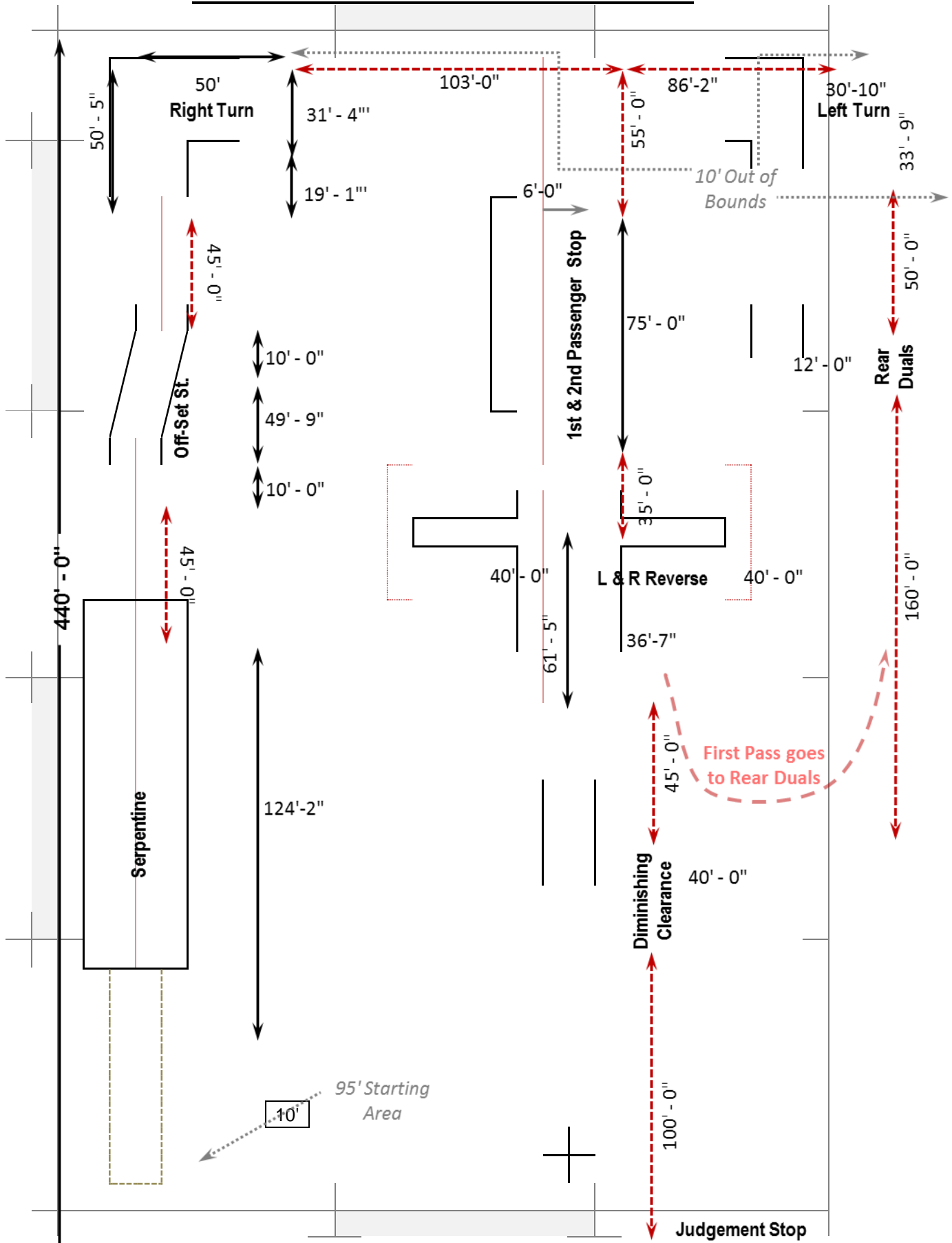

Appendix 4: Operator's Obstacle Descriptions

Serpentine

This obstacle tests a driver's ability to negotiate tight turns. The driver is required to enter a gate, steer in and out through three cones, and exit the obstacle through another gate. The bus is not permitted to touch any portion of any cone.

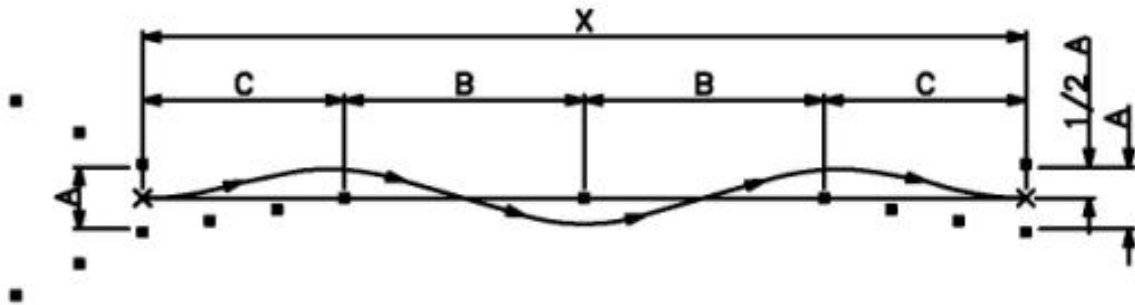

40' x 102" BUS:

- A = 9'-6"
- B = 36'-0"
- C = 32'-0"
- X = 136'-0"

35' x 96" BUS:

- A = 9'-0"
- B = 32'-0"
- C = 25'-7"
- X = 115'-0"

LEGEND

- 28" CONE
- PATH OF BUS
- X—X SURVEY BASELINE

NOT TO SCALE

Offset Street

In this obstacle, the driver is required to drive through two separate narrow lanes that are offset to the right one full lane's width from each other.

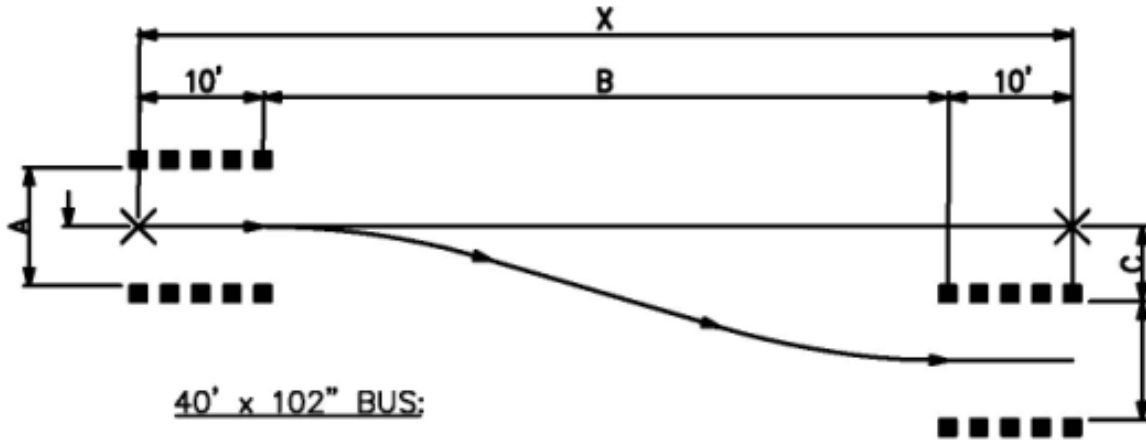

40' x 102" BUS:

A = 9'-6"
 B = 55'-0"
 C = 6'-0"
 X = 75'-0"

35' x 96" BUS:

A = 9'-0"
 B = 48'-0"
 C = 4'-9"
 X = 68'-0"

LEGEND

- 28° CONE
 - PATH OF BUS
 - × SURVEY BASELINE
- NOT TO SCALE

Rear Duals Clearance

This is a judgment obstacle in which the driver must drive through a line with their right dual tires. The lane is only slightly wider than the total outside width of a pair of rear duals and is marked out with large flat washers and tennis balls. It is wider at the entrance and narrower at the exit.

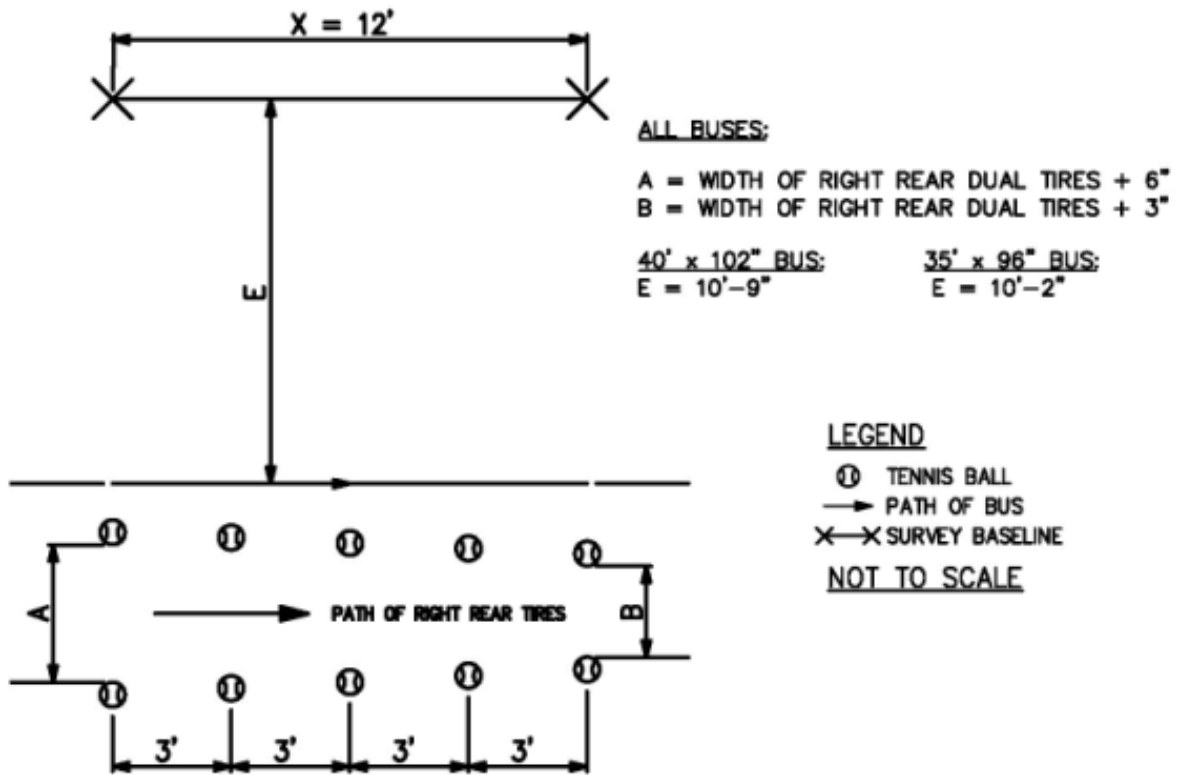

Right Hand Turn

This obstacle tests a driver's ability to negotiate a right 90 degree turn. The corner is marked with cones and the rear tire of the bus is to pass within 6 inches of the corner pivot cone.

To measure this, a line should be marked out of 45 degrees from the corner and divided into six inch segments. The judge has only to see which segment the outside of the tire passes over in order to judge the driver.

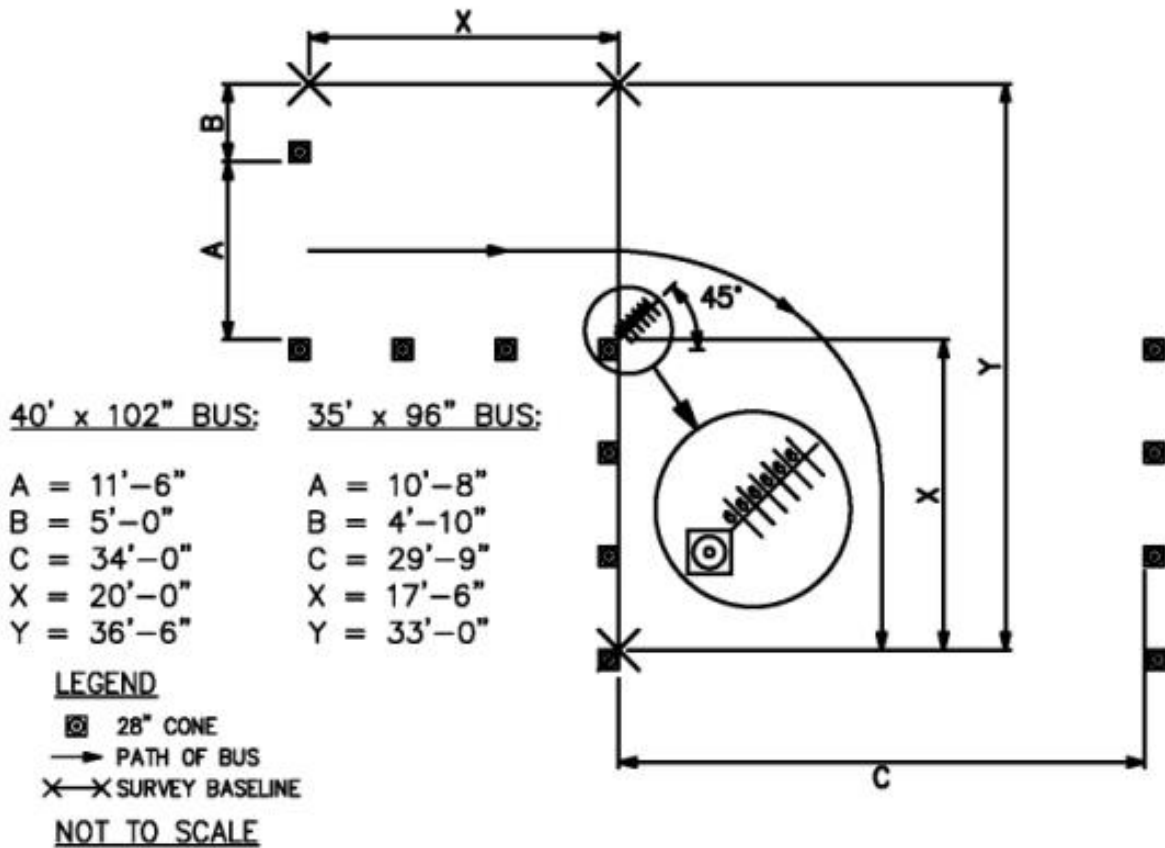



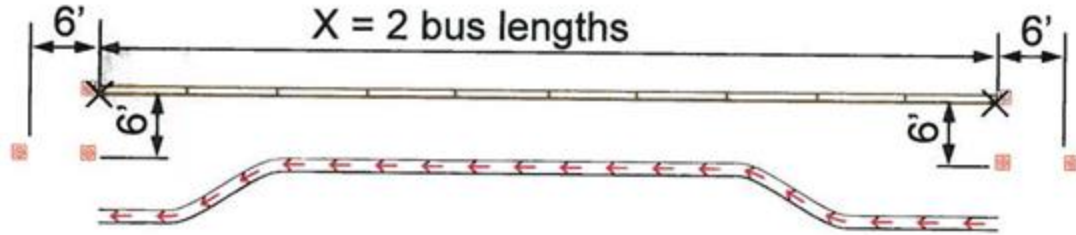

First & Second Customer Stop

In this obstacle the operator is required to stop the bus with the front wheels within 6 inches of the curb and the rear wheels within 15 inches of the curb.



LEGEND

-  Railroad tie
-  28" Cone
-  Path of bus
-  Survey baseline

NOT TO SCALE

Left- and Right-Hand Reverse

This obstacle requires the operator to reverse the bus to the right or left between a set of cones stopping with the rear bumper within 36 inches of the cone in the rear without touching any of the cones.

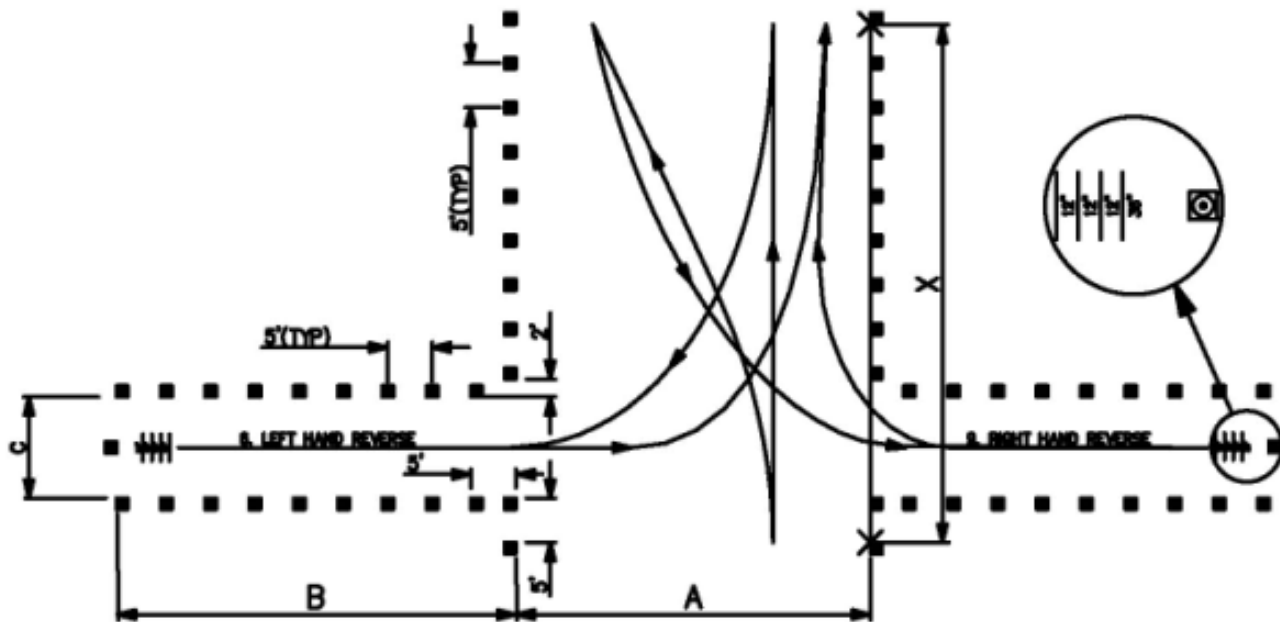

40' x 102" BUS:

A = 40'-0"
 B = 45'-0"
 C = 11'-5"
 X = 58'-5"

35' x 96" BUS:

A = 35'-0"
 B = 40'-0"
 C = 10'-11"
 X = 57'-11"

LEGEND

- 28" CONE
- PATH OF BUS
- × SURVEY BASELINE

NOT TO SCALE

Left Hand Turn

This obstacle tests a driver's ability to make a tight left turn in a close situation. The driver is required to steer the bus into a 90 degree turn and not hit any of the cones outlining the obstacle.

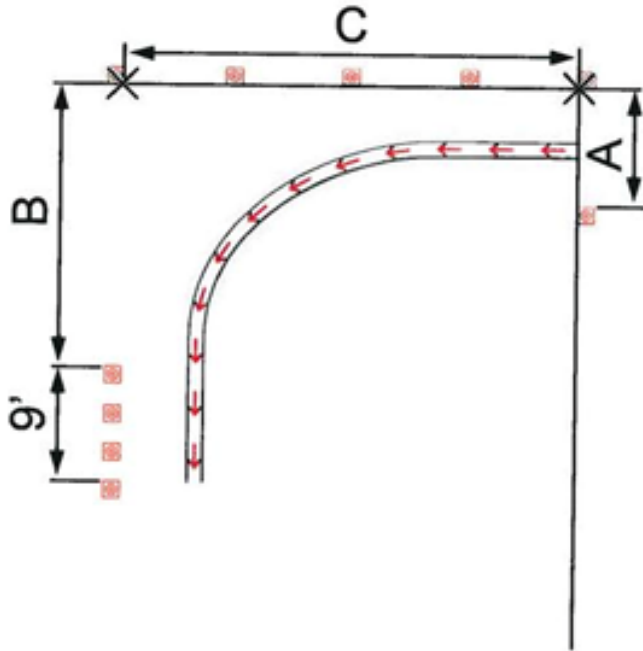



40' x 102'' Bus:

A = 9'-9"
B = 23'-0"
C = 36'-7"

35' x 96'' Bus:

A = 9'-3"
B = 20'-3"
C = 32'-2"

LEGEND

-  28" Cone
-  Path of bus
-  Survey baseline

NOT TO SCALE

Diminishing Clearance

This obstacle tests the driver's ability to judge position and speed of their vehicles. The driver is required to drive through a narrowing v-shaped channel outlined with barrels, while obtaining a minimum speed of 20 miles per hour.

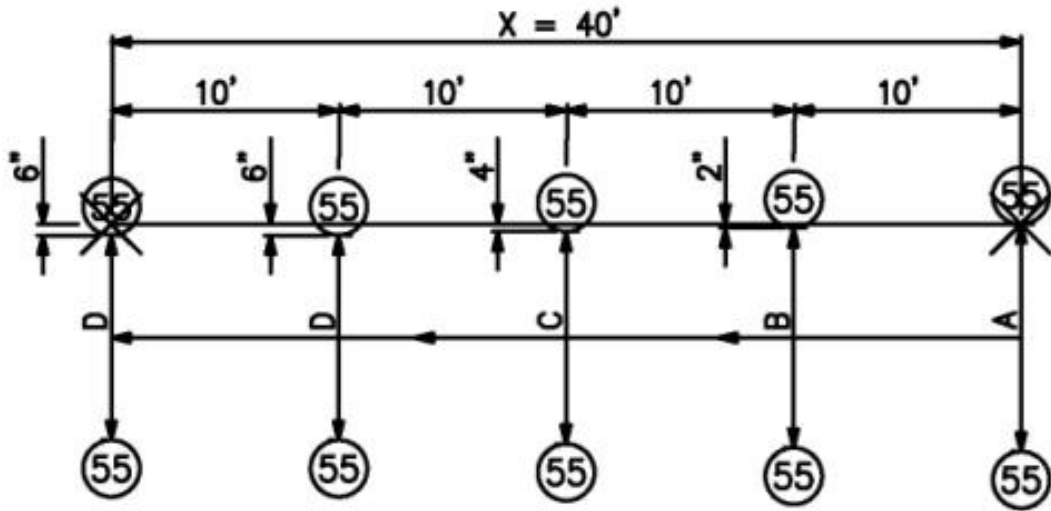

40' x 102" BUS:

A = 10'-0"
 B = 9'-8"
 C = 9'-4"
 D = 9'-0"
 X = 40'-0"

35' x 96" BUS:

A = 9'-6"
 B = 9'-2"
 C = 8'-10"
 D = 8'-6"
 X = 40'-0"

LEGEND

- (55) 55 GALLON DRUM
- PATH OF BUS
- X—X SURVEY BASELINE
- NOT TO SCALE

Judgment Stop

This obstacle tests a driver's ability to judge stopping distances between the bus and a small object directly ahead. A small (18 inch) cone is placed on the finish line, the driver's final stop. The bus must stop with the front bumper within 6 inches of the cone.

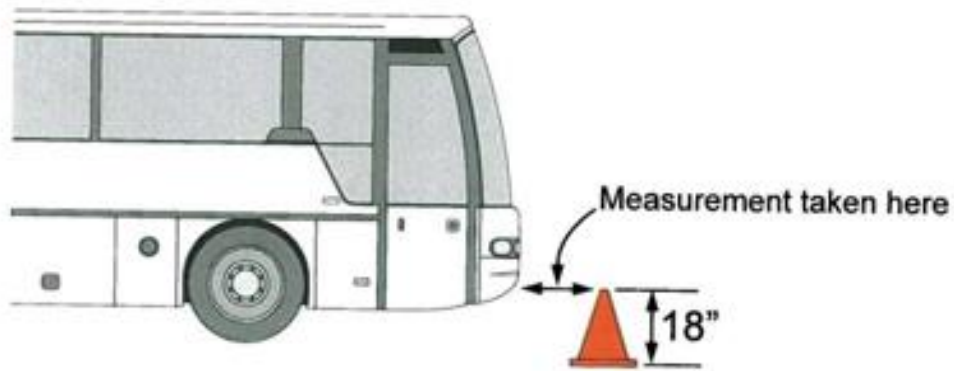

Pre-Trip Inspection Score Sheet

Operator Number: _____

Bus Number: _____

A. Points Earned

Identify and record eight (8) planted defects (5 points each).
Identify and record one (1) security problem (10 points).

1. Number of planted defects found _____ x 5 = _____

2. Security problem found (enter 0 or 10) _____

Total Points Earned A. _____

B. Penalty

Deduct 1 point for each item not returned to original condition.
(examples: compartment doors, lights, windows, etc.)

1. Number of items not returned to original condition
_____ x 1

Total Points Deducted B. _____

TOTAL POINTS EARNED (A-B)
(Maximum Possible 50 points)

Judge's Signature: _____

Judge's Signature: _____

2. SERPENTINE

Contestant's Number: _____

Bus Number: _____

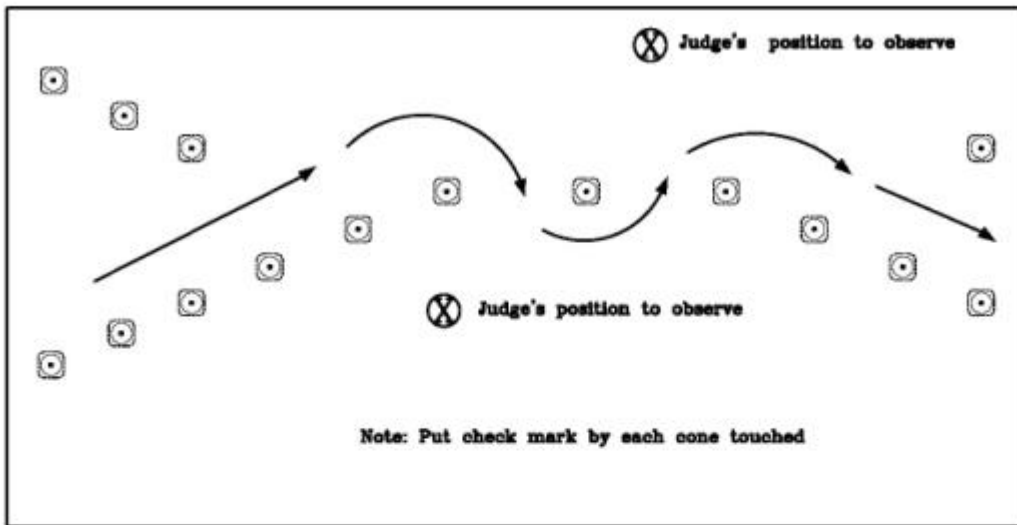

Penalties

1. 10 points off for each cone touched.
2. 10 points off for each transmission shift into reverse.
3. 25 points off for touching pivot cone.
4. 50 points off for not completing test as designed.

Score

- | | | | |
|------------------------------------|-------|--------|-------|
| 1. Cones touched | _____ | x 10 = | _____ |
| 2. Shifted into reverse | _____ | x 10 = | _____ |
| 3. Pivot cone touched | _____ | x 25 = | _____ |
| 4. Not completing test as designed | _____ | x 50 = | _____ |

TOTAL POINTS OFF (Add 1 thru 4) _____

Note: Maximum Penalty Points=50

JUDGE'S SIGNATURE: _____ Total Points Possible 50

JUDGE'S SIGNATURE: _____ Less Total Points Off _____

POINTS EARNED

3. OFFSET STREET

Contestant's Number: _____

Bus Number: _____

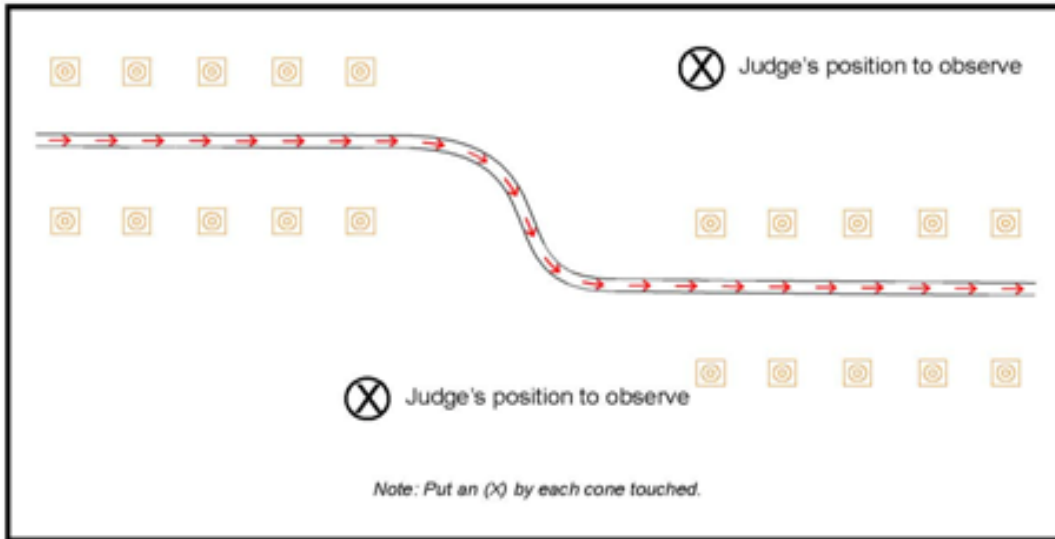

Penalties

1. 10 points off for each cone touched.
2. 10 points off for each transmission shift into reverse.
3. 50 points off for not completing test as designed.

Score

- | | |
|------------------------------------|--------------------|
| 1. Cones touched | _____ x 10 = _____ |
| 2. Shifted into reverse | _____ x 10 = _____ |
| 3. Not completing test as designed | _____ x 50 = _____ |

Total Points Off (add 1 thru 3) _____

Note: Maximum Penalty Points = 50

Judge's Signature: _____
 Judge's Signature: _____

Total Points Possible 50
 Total Points Off _____

POINTS EARNED

4. REAR DUALS CLEARANCE

Contestant's Number: _____

Bus Number: _____

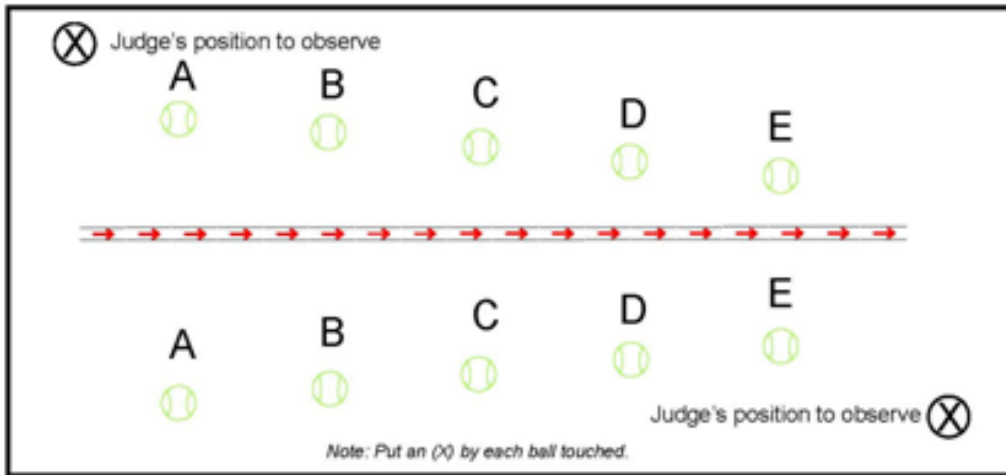

Penalties

1. 20 points off for each "A" ball touched.
2. 16 points off for each "B" ball touched.
3. 8 points off for each "C" ball touched.
4. 4 points off for each "D" ball touched.
5. 2 points off for each "E" ball touched.
6. 10 points off for each transmission shift into reverse.
7. 50 points off for not completing test as designed.

Score

- | | |
|------------------------------------|--------------------|
| 1. "A" ball touched | _____ x 20 = _____ |
| 2. "B" ball touched | _____ x 16 = _____ |
| 3. "C" ball touched | _____ x 8 = _____ |
| 4. "D" ball touched | _____ x 4 = _____ |
| 5. "E" ball touched | _____ x 2 = _____ |
| 6. Shifted into reverse | _____ x 10 = _____ |
| 7. Not completing test as designed | _____ x 50 = _____ |

Total Points Off (add 1 thru 7)

Note: Maximum Penalty Points = 50

Judge's Signature: _____

Total Points Possible 50

Judge's Signature: _____

Total Points Off _____

POINTS EARNED

5. RIGHT HAND TURN

Contestant's Number: _____

Bus Number: _____

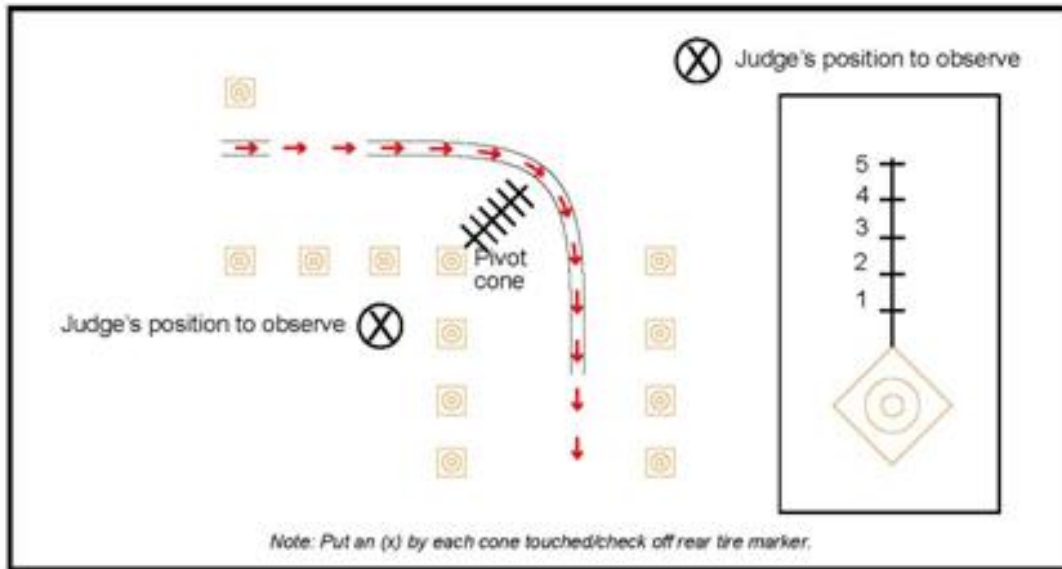

Penalties

1. 10 points off for each cone touched.
2. 5 points off for each 6" segment beyond the first 6" of the pivot cone.
3. 10 points off for each transmission shift into reverse.
4. 25 points off for touching pivot cone.
5. 50 points off for not completing test as designed.

Score

- | | |
|------------------------------------|--------------------|
| 1. Cones touched | _____ x 10 = _____ |
| 2. Excessive rear tire clearance | _____ x 5 = _____ |
| 2. Shifted into reverse | _____ x 10 = _____ |
| 3. Pivot cone touched | _____ x 25 = _____ |
| 4. Not completing test as designed | _____ x 50 = _____ |

Total Points Off (add 1 thru 5) _____

Note: Maximum Penalty Points = 50

Judge's Signature: _____

Judge's Signature: _____

Total Points Possible 50

Total Points Off _____

POINTS EARNED

6. FIRST CUSTOMER STOP

Contestant's Number: _____

Bus Number: _____

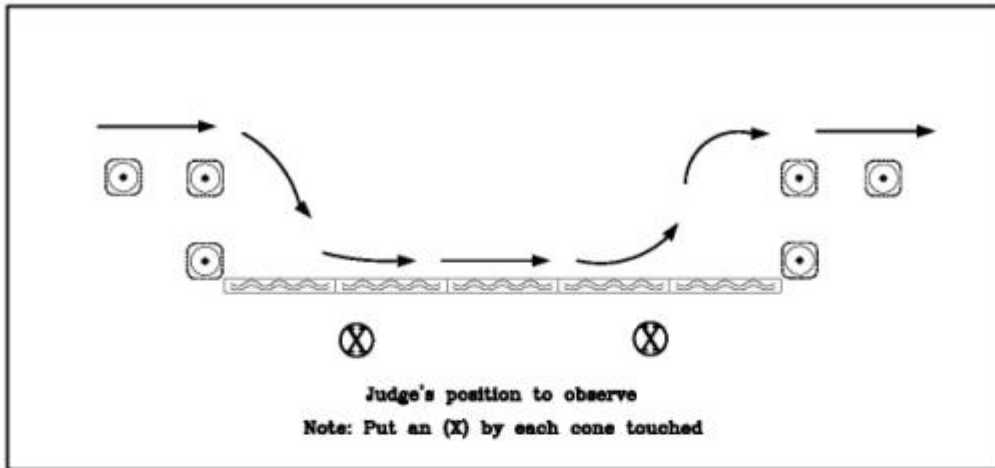

Penalties

1. 25 points off for touching cones at either end of passenger stop
2. 25 points off for touching curb with tires
3. 1 point off per inch beyond 6" segment from curb (FRONT TIRE)
4. 1 point off per inch beyond 15" segment from curb (REAR TIRE)
5. 10 points off for each transmission shift into reverse
6. 50 points off for not completing test as designed

Score

1. Entrance cones touched	_____ x25= _____
2. Touched curb	_____ x25= _____
3. Front tire actual measurement	_____ " -6= _____
4. Rear tire actual measurement	_____ " -15= _____
5. Exit cones touched	_____ x25= _____
6. Shifted into reverse	_____ x10= _____
7. Not completing test as designed	_____ x50= _____

TOTAL POINTS OFF (Add 1 thru 7) _____

Note: Maximum Penalty Points=50

JUDGE'S SIGNATURE: _____ Total Points Possible 50

JUDGE'S SIGNATURE: _____ Total Points OFF _____

POINTS EARNED

7. LEFT HAND REVERSE

Contestant's Number: _____

Bus Number: _____

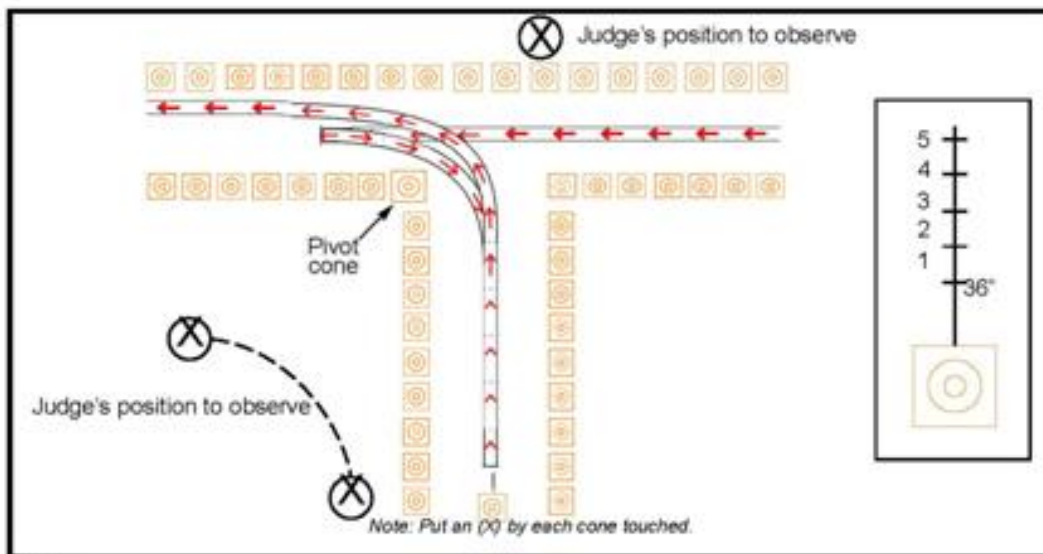

Penalties

1. 10 points off for pivot cone touched.
2. 5 points off for each cone touched.
3. 5 points off for each 12" segment beyond 36" limit from rear cone.
4. 10 points off for each transmission shift into reverse after initial shift into reverse.
5. 25 points off for touching rear cone.
6. 50 points off for not completing test as designed.

Score

- | | | | |
|------------------------------------|-------|--------|-------|
| 1. Pivot cone touched | _____ | x 10 = | _____ |
| 2. Cones touched | _____ | x 5 = | _____ |
| 3. Rear clearance beyond 36" | _____ | x 5 = | _____ |
| 4. Shifted into reverse | _____ | x 10 = | _____ |
| 5. Rear cone touched | _____ | x 25 = | _____ |
| 6. Not completing test as designed | _____ | x 50 = | _____ |

Total Points Off (add 1 thru 6)

Note: Maximum Penalty Points = 50

Judge's Signature: _____

Judge's Signature: _____

Total Points Possible 50

Total Points Off _____

POINTS EARNED

8. LEFT HAND TURN

Contestant's number: _____

Bus Number: _____

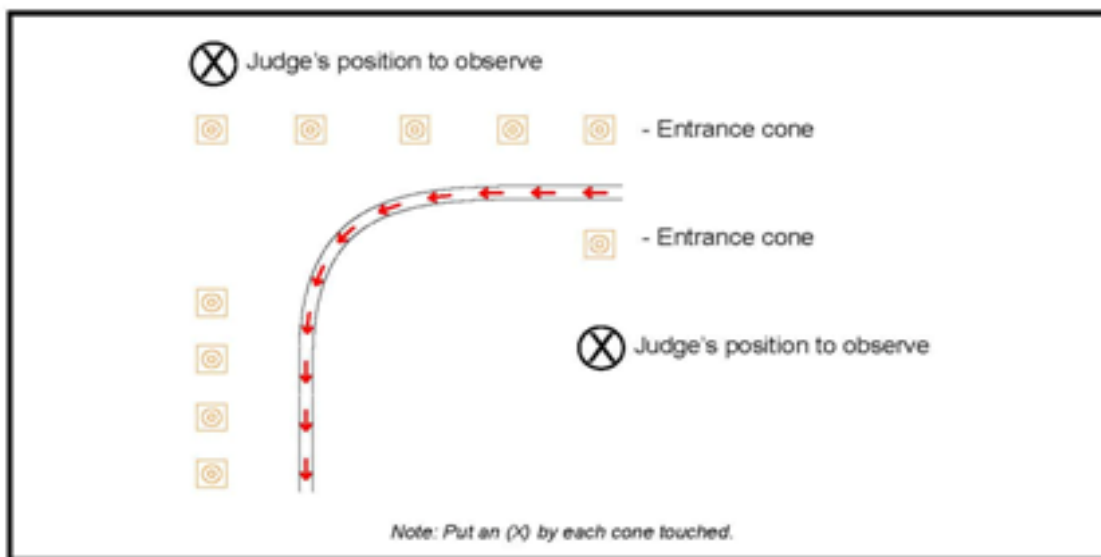

Penalties

1. 10 points off for each cone touched.
2. 10 points off for each transmission shift into reverse.
3. 25 points off for touching entrance cone.
4. 50 points off for not completing test as designed.

Score

- | | |
|------------------------------------|--------------------|
| 1. Cones touched | _____ x 10 = _____ |
| 2. Shifted into reverse | _____ x 10 = _____ |
| 3. Entrance cone touched | _____ x 25 = _____ |
| 4. Not completing test as designed | _____ x 50 = _____ |

Total Points Off (add 1 thru 4)

Note: Maximum Penalty Points = 50

Judge's Signature: _____

Judge's Signature: _____

Total Points Possible 50

Total Points Off _____

POINTS EARNED

9. SECOND CUSTOMER STOP

Contestant's Number: _____

Bus Number: _____

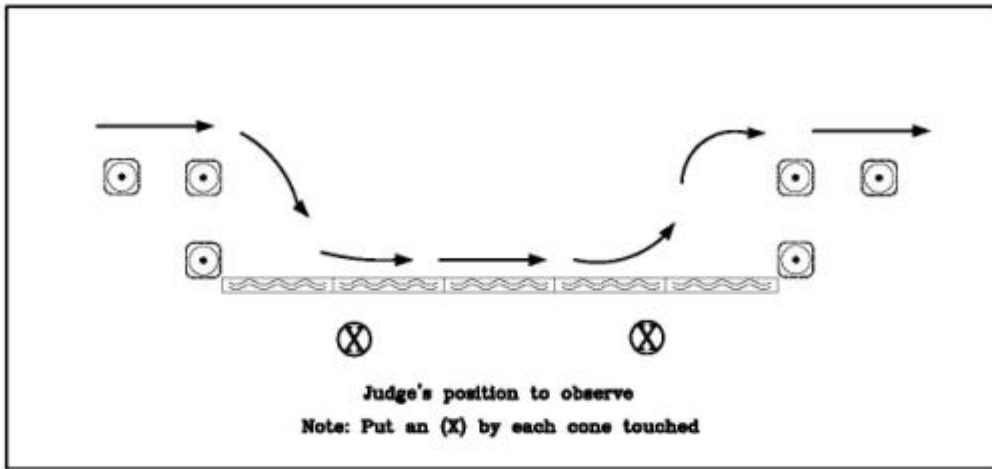

Penalties

1. 25 points off for touching cones at either end of passenger stop
2. 25 points off for touching curb with tires
3. 1 point off per inch beyond 6" segment from curb (FRONT TIRE)
4. 1 point off per inch beyond 15" segment from curb (REAR TIRE)
5. 10 points off for each transmission shift into reverse
6. 50 points off for not completing test as designed

Score

1. Entrance cones touched	_____ x25= _____
2. Touched curb	_____ x25= _____
3. Front tire actual measurement	_____ "-6= _____
4. Rear tire actual measurement	_____ "-15= _____
5. Exit cones touched	_____ x25= _____
6. Shifted into reverse	_____ x10= _____
7. Not completing test as designed	_____ x50= _____

TOTAL POINTS OFF (Add 1 thru 7) _____

Note: Maximum Penalty Points=50

JUDGE'S SIGNATURE: _____ Total Points Possible 50

JUDGE'S SIGNATURE: _____ Total Points OFF _____

POINTS EARNED

10. RIGHT HAND REVERSE

Contestant's Number: _____

Bus Number: _____

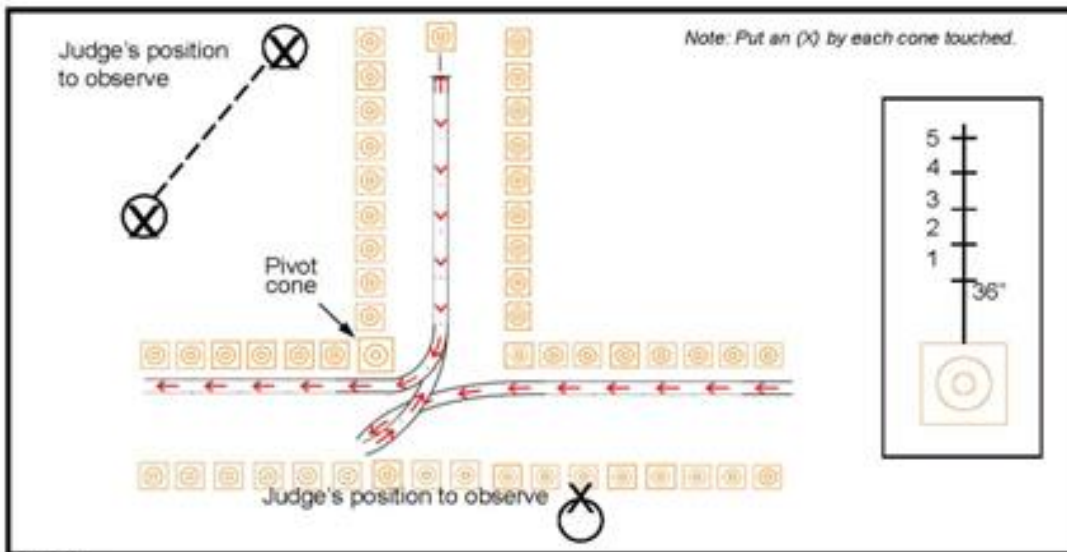

Penalties

1. 10 points off for pivot cone touched.
2. 5 points off for each cone touched.
3. 5 points off for each 12" segment beyond 36" limit from rear cone.
4. 10 points off for each transmission shift into reverse after initial shift into reverse.
5. 25 points off for touching rear cone.
6. 50 points off for not completing test as designed.

Score

- | | |
|------------------------------------|--------------------|
| 1. Pivot cone touched | _____ x 10 = _____ |
| 2. Cones touched | _____ x 5 = _____ |
| 3. Rear clearance beyond 36" | _____ x 5 = _____ |
| 4. Shifted into reverse | _____ x 10 = _____ |
| 5. Rear cone touched | _____ x 25 = _____ |
| 6. Not completing test as designed | _____ x 50 = _____ |

Total Points Off (add 1 thru 6)

Note: Maximum Penalty Points = 50

Judge's Signature: _____

Judge's Signature: _____

Total Points Possible 50

Total Points Off _____

POINTS EARNED

11. DIMINISHING CLEARANCE

Contestant's Number: _____

Bus Number: _____

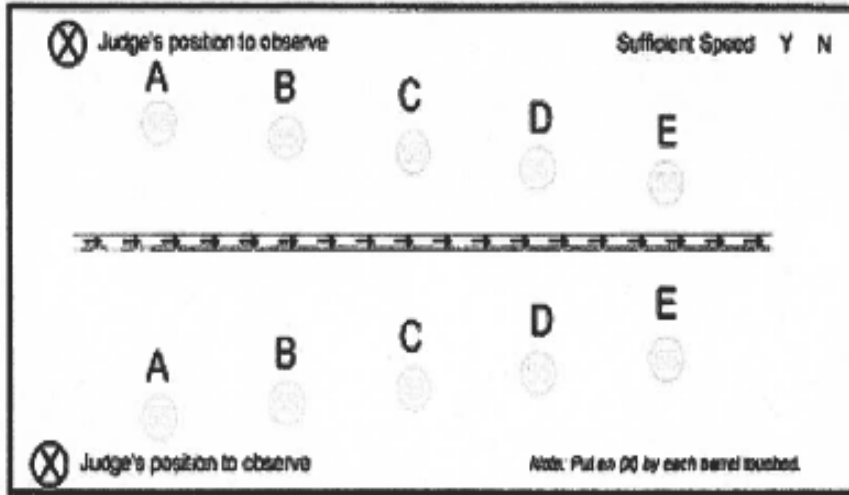

Penalties

1. 20 points off for each "A" barrel touched.
2. 16 points off for each "B" barrel touched.
3. 8 points off for each "C" barrel touched.
4. 4 points off for each "D" barrel touched.
5. 2 points off for each "E" barrel touched.
6. 25 points off for insufficient speed (20 mph).
7. 50 points off for not completing test as designed.

Score

- | | |
|------------------------------------|--------------------|
| 1. "A" barrel touched | _____ x 20 = _____ |
| 2. "B" barrel touched | _____ x 16 = _____ |
| 3. "C" barrel touched | _____ x 8 = _____ |
| 4. "D" barrel touched | _____ x 4 = _____ |
| 5. "E" barrel touched | _____ x 2 = _____ |
| 6. Insufficient speed | _____ x 25 = _____ |
| 7. Not completing test as designed | _____ x 50 = _____ |

Total Points Off (add 1 thru 7) _____

Note: Maximum Penalty Points = 50

Judge's Signature: _____

Judge's Signature: _____

Total Points Possible 50

Total Points Off _____

POINTS EARNED

12. JUDGMENT STOP

Contestant's Number: _____

Bus Number: _____

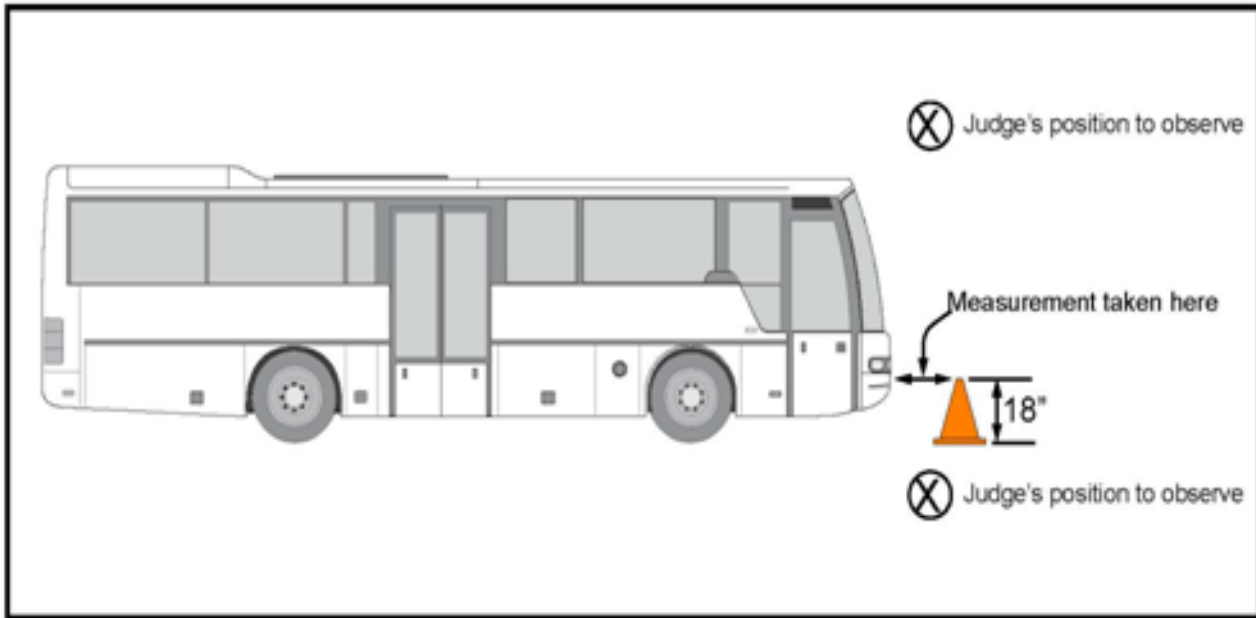

Penalties

1. 50 points off for the 18" marker being touched.
2. 1 point off for each 1" beyond the initial 6".
3. 25 points off for making more than one full stop.
4. 50 points off for not completing test as designed.

Score

1. 18" marker touched _____ yes _____ no = _____
2. Excessive clearance beyond 6" limit
 Actual measurement _____ -6 = _____
3. Excessive total stops _____ x 25 = _____
4. Not completing test as designed _____ x 50 = _____

Total Points Off (add 1 thru 4) _____

Note: Maximum Penalty Points = 50

Judge's Signature: _____

Judge's Signature: _____

Total Points Possible 50

Total Points Off _____

POINTS EARNED

13. SAFETY HABITS

Contestant's Number _____

Bus Number _____

A. Total Points Possible

A: 25

B. Deductions

1. Deduct 1 point for each instance of failing to use proper turn signals _____ x 1 = _____
2. Deduct 3 points for each instance of failing to sound the horn before backing up _____ x 3 = _____
3. Deduct 3 points for each instance of failing to use flashers while backing up _____ x 3 = _____
4. Deduct 3 points for each instance of moving bus with door opened _____ x 3 = _____
5. Deduct 5 points for failing to use seat belt _____ x 5 = _____
6. Deduct 2 points if the Operator exhibits poor:
 - a. Posture Enter 0 or 2 _____
 - b. Use of mirrors Enter 0 or 2 _____
 - c. Use of hands Enter 0 or 2 _____
 - d. Use of feet Enter 0 or 2 _____

Total Points Deducted (Add 1 - 6)
(maximum penalty points – 25)

B: _____

TOTAL POINTS AWARDED (A– B)
(maximum 25 points)

Judge's Signature _____

Judge's Signature _____

14. SMOOTHNESS OF OPERATION

Contestant's Number _____

Bus Number _____

Evaluate each contestant on his/her ability to deliver a smooth ride. The following criterion is to be employed in making each evaluation:

A. Total Points Possible

A: 25

B. Penalties:

Deduct 10 points for each A.D.A. announcement not made.

Deduct one point for each occurrence of sudden stops, sudden starts and abrupt turns.

1. A.D.A. Announcements _____ x 10 = _____

2. Sudden Stops _____ x 1 = _____

3. Sudden Starts _____ x 1 = _____

4. Abrupt turns _____ x 1 = _____

TOTAL POINTS DEDUCTED (Add 1 - 4) **B:** _____
(maximum penalty points – 25)

TOTAL POINTS AWARDED (A-B)
(maximum 25 points)

Judge's Signature _____

Judge's Signature _____

15. PERSONAL APPEARANCE

Contestant's Number _____

Bus Number _____

A. Total Points Possible

A: 50

B. Deductions:

Deduct 10 points for each instance of poor personal appearance
(examples: wrinkled uniform, unkempt personal appearance, unpolished or dirty shoes)

Number of Deductions Noted: _____ x 10 =
(maximum of 5 deductions)

B: _____

Explanation of Deductions Noted: _____

TOTAL POINTS AWARDED (A-B)
(maximum 50 points)

Judge's Signature _____

16. TIMEKEEPER'S RECORD

Contestant's Number _____

Bus Number _____

NOTE: Time stops for mechanical trouble and at each course problem where measurements are taken. Time stops at the completion of the judgment stop.

A. Elapsed Time: _____ minutes _____ seconds

B. Penalty of one point per second over seven minutes.
(Maximum penalty of 180 points)

POINTS PENALIZED

TIMEKEEPER'S SIGNATURE _____

SCORE SHEET SUMMARY

Contestant's Number _____

Contestant Agency _____

EVENT	POINTS POSSIBLE	POINTS EARNED
1. Pre-Trip Inspection	50	_____
2. Serpentine	50	_____
3. Offset Street	50	_____
4. Rear Duals Clearance	50	_____
5. Right Hand Turn	50	_____
6. 1 st Customer Stop	50	_____
7. Left Hand Reverse	50	_____
8. Left Hand Turn	50	_____
9. 2 nd Customer Stop	50	_____
10. Right Hand Reverse	50	_____
11. Diminishing Clearance	50	_____
12. Judgment Stop	50	_____
13. Safety Habits	25	_____
14. Smoothness of Operations /ADA	25	_____
15. Personal Appearance	50	_____
16. Paratransit Test		_____
17. Passenger Assistance/Wheelchair Securement		_____

TOTAL

OPERATORS SUB-TOTAL

16. Timekeeper's Record

A: Elapsed Time: _____ Minutes _____ Seconds

B: Overtime Penalty

(Deduct 1 point for each second over 7 minutes
not to exceed maximum penalty of 180 points)

OPERATOR GRAND TOTAL

Recorder's Signature: 1st Tally _____ Recheck _____ Date _____/_____/_____

Recorder's Signature: 1st Tally _____ Recheck _____ Date _____/_____/_____

Recorder's Signature: 1st Tally _____ Recheck _____ Date _____/_____/_____